

# Bitucell\*

## Bitumen impregnated fibreboard

### Uses

Bitucell is a compressible, non-extruding, bitumen impregnated fibreboard expansion joint filler suitable for forming joints in in-situ or precast concrete components, and to protect waterproof membranes against physical or mechanical damage.

Forming structural expansion and separation joints in:

- Concrete pavements and floors
- Roads, ramps and runways
- Pedestrian areas
- Concrete retaining walls and bridges
- Concrete basement structures and subways

### Advantages

- Easy to handle, cut and tamp
- Resilient
- Will not extrude under compression
- High recovery
- Low distortion

### Standards compliance

Bitucell has been independently tested and complies with DTp Specification for Highway Works, Dec 1991 series 1000 clause 1015.

### Description

Bitucell is a compressible joint filler and protection board manufactured from bitumen impregnated wood fibres. It is supplied in sheet form and is used to form and fill expansion joints in in-situ and precast concrete construction.

### Specification

The expansion joint filler as detailed shall be Bitucell supplied by Al Gurg Fosroc LLC.

The expansion joint filler will have been independently tested and exceed the requirements of the UK Department of Transport Specification for Highway Works series 1000, clause 1015.

### Design criteria

Typical sealed expansion joints in roads, industrial floors, runways and other trafficked surfaces.

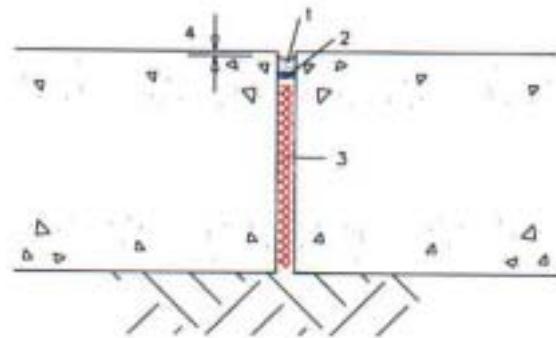

- 1 Colpor 200
- 2 Bond breaking tape
- 3 Bitucell
- 4 Recessed seal

An example of a sealed substructure expansion joint is shown below.

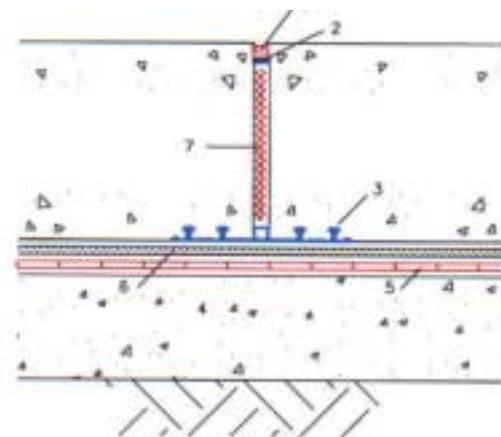

- 1 Thioflex 600
- 2 Bond breaking tape
- 3 Supercast rearguard 'S' waterstop
- 4 Blinding concrete
- 5 Proofex GPX or 12X membrane
- 6 Fosroc Protection Board
- 7 Bitucell

# Bitucell\*

## Properties

<b>Form</b>	: Compressible sheet
<b>Solids content</b>	: 100%
<b>Recovery</b>	: > 85% (ASTM D1751)
<b>Weathering test</b>	: No disintegration (DTp CI 1015)
<b>Extrusion</b>	: < 1.2 mm (ASTM D1751)
<b>Distortion</b>	: < 0.7 mm (ASTM D944)
<b>Brittleness</b>	: Does not crack or shatter (ASTM D944)

The above properties were determined by independent tests on 25mm thick samples.

## Instructions for use

### Slabs

Where used to form an expansion joint in in-situ concrete, Bitucell shall be placed against the shuttering on the concreting side before the pour begins. Copper nails may be used to prevent displacement in joints in suspended slabs.

Alternatively, Bitucell may be bonded to the existing slab or previous pour using a suitable contact adhesive. Care should be taken not to contaminate surfaces of the sealing slot with the adhesive.

### Joint sealing

A joint sealing slot can be formed by placing a removable timber former on top of the Bitucell. Alternatively, Bitucell can be installed to the full depth of the slab and cut back to the required depth subsequently using a power brush machine. This latter method is generally used for slabs which cannot be cleaned and sealed until all building construction has finished. Bitucell should be tamped down to ensure that it fills the joint completely and provides continuous support for the joint sealant.

## Technical support

Fosroc offers a comprehensive technical support service to specifiers, end users and contractors. It is also able to offer on-site technical assistance, an AutoCAD facility and dedicated specification assistance in locations all over the world.

## Estimating

### Supply

<b>Bitucell</b>	: 1.22 m x 2.20 m
<b>Nominal sheet</b>	
<b>Thickness</b>	: 12 mm    19 mm    25 mm

## Storage

As with all organic materials there is a very slight risk of spontaneous combustion if stored long term in wet conditions. Store under cover, in a dry, flat, clean and sound conditions.

## Precautions

### Health and safety

There are no health hazards associated with Bitucell in normal use.

### Fire

Bitucell is combustible and will catch fire if exposed to flame or other sources of ignition.

\* Denotes the trademark of Fosroc International Limited

\* Denotes the trademark of Fosroc International Limited

† See separate data sheet



Al Gurg Fosroc  
LLC

Post Box 657, Dubai  
United Arab Emirates

[www.fosroc.com](http://www.fosroc.com)

## Important note

Fosroc products are guaranteed against defective materials and manufacture and are sold subject to its standard Conditions for the Supply of Goods and Service. All Fosroc datasheets are updated on a regular basis. It is the user's responsibility to obtain the recent version. Refer to [www.fosroc.com](http://www.fosroc.com).

### Head Office

**telephone:** (+9714) 2039699

**fax:** (+9714) 2859649

**email:** [agf@fosroc.com](mailto:agf@fosroc.com)

### Regional offices

Abu Dhabi, Al Gurg Fosroc  
Bahrain, YBA Kanoo  
Kuwait, Boodai  
Oman, Al Amana  
Qatar, Tadmur

**telephone:** 673 1779  
**telephone:** 17735454  
**telephone:** 4817618  
**telephone:** 24815080  
**telephone:** 4500607

**fax:** 673 1449  
**fax:** 17732828  
**fax:** 4832124  
**fax:** 24817554  
**fax:** 4500543

**email:** [abudhabi@fosroc.com](mailto:abudhabi@fosroc.com)  
**email:** [bahrain@fosroc.com](mailto:bahrain@fosroc.com)  
**email:** [kuwait@fosroc.com](mailto:kuwait@fosroc.com)  
**email:** [oman@fosroc.com](mailto:oman@fosroc.com)  
**email:** [qatar@fosroc.com](mailto:qatar@fosroc.com)

